

# Sullivan's Island Stith Park

## Preliminary Opinion of Probable Construction Costs

Prepared By:  THOMAS & HUTTON

JOB: 30388.0000

DATE: 02.22.2024

BY: RJW

SITE DRAINAGE (CIVIL)					
#	Item	QTY.	Unit	Unit Price	Total
1	Inlets	10	each	\$6,000	\$60,000
2	Control Structure	1	each	\$9,000	\$9,000
3	18-Inch Drainage pipes	500	lf	\$180	\$90,000
4	24-Inch Drainage pipes	1,150	lf	\$200	\$230,000
5	36-Inch Drainage pipes	125	lf	\$250	\$31,250
6	Drainage Swales	200	lf	\$30	\$6,000
<b>SITE DRAINAGE TOTAL:</b>					<b>\$426,250.00</b>

SITE - PARKING (CIVIL)					
#	Item	QTY.	Unit	Unit Price	Total
1	Parking - Concrete	180	sy	\$120	\$21,600
2	Parking - Gravel	900	sy	\$35	\$31,500
3	Sidewalk	100	sy	\$90	\$9,000
4	24" SCDOT Driveway	35	sy	\$125	\$4,375
5	Striping and Signage	1	job	\$5,500	\$5,500
6	Existing Water Hydrant relocation	1	job	\$5,500	\$5,500
7	*Existing Power Line Relocation				TBD
<b>SITE PARKING TOTAL:</b>					<b>\$77,475.00</b>

\*Existing Power line Relocation not included in Site Parking Total

SITE - PLANTING					
#	Item	QTY.	Unit	Unit Price	Total
1	Type a Landscaping - Grove / Playground	20800	s.f.	\$3.50	\$72,800.00
2	Type B Landscaping - Passive Space / Buffers / Mound	52000	s.f.	\$2.50	\$130,000.00
3	Fine Grading and Hydro Seeding Multi-Use Field	60000	sf	\$0.85	\$51,000.00
4	Irrigation	1	al	\$125,000.00	\$125,000.00
<b>PLANTING TOTAL:</b>					<b>\$378,800.00</b>

SITE - HARDSCAPE					
#	Item	QTY.	Unit	Unit Price	Total
1	Demo Existing Hardscape / Playground	1	al	\$10,000.00	\$10,000.00
2	6' Path / Trail w/ Steel Edging - Sand Shell (Flat)	13350	s.f.	\$7.25	\$96,787.50
3	4' Path / Trail w/ Steel Edging - Sand Shell (On Slope)	5500	s.f.	\$23.00	\$126,500.00
4	Specialty Pavers	6000	s.f.	\$12.00	\$72,000.00
5	Pickle Ball Court, Color Coated Asphalt	2	al	\$45,000.00	\$90,000.00
6	Sport Court Lighting	1	al	\$70,000.00	\$70,000.00
7	Bambo Root Barrier (30" Depth)	700	l.f.	\$35.00	\$24,500.00
8	Site Furnishings	1	al	\$80,000.00	\$80,000.00
9	Landscape / Pedestrian Lighting	1	al	\$90,000.00	\$90,000.00
<b>HARDSCAPE TOTAL:</b>					<b>\$649,787.50</b>

<b>SUB TOTAL</b>				<b>\$1,532,312.50</b>
<b>20% CONTIGENCY</b>				<b>\$306,462.50</b>
<b>SITE TOTAL</b>				<b>\$1,838,775.00</b>

PLAYGROUND					
#	Item	QTY.	Unit	Unit Price	Total

See Opinion of Cost for a Earthscape Playground provided by Great Southern Recreation

STRUCTURES					
#	Item	QTY.	Unit	Unit Price	Total
	Community Pavilion	1	al	\$200,000 to \$275,000	
	Observation Tower	1	al	\$325,000 to \$475,000	
	Pickleball Pavilion	1	al	\$50,000 to \$75,000	

### NOTES:

- 1) This opinion of probable cost is based on the **Final Masterplan Plan** dated February 2024, and is not based on detailed site development plans.
- 2) This opinion of probable cost is based off of past projects and historical bids in the region.
- 3) This opinion of probable cost **does not include design fees**.
- 4) Fees provided herein are for budget purposes only and are based solely on a conceptual plan.
- 5) Planting quantities are based off of a conceptual plan and are subject to change.

Since the Engineer and Landscape Architect has no control over the cost of labor, materials, equipment, or services furnished by others, or over the Contractor's methods of determining prices, or over competitive bidding, or market conditions, his opinions of probable project cost and construction cost provided herein are to be made on the basis of his experience and qualifications and represent his best judgment as an experienced and qualified professional, familiar with the construction industry; but Landscape Architect cannot and does not guarantee that proposals, bids or actual project or construction cost will not vary from opinions of probable cost prepared.



<b>ORGANIZATION:</b>	
<b>CONTACT:</b>	
<b>ADDRESS:</b>	
<b>PHONE:</b>	

<b>PROJECT TITLE:</b>	Sullivans Island Playspace
<b>REVISION:</b>	
<b>OPTION:</b>	1

## Estimate from Great Southern Recreation

TERRITORY MANAGER	DATE	TERRITORY	COUNTY	TERMS	COLORS
	2/15/2024			Net 30	Confirmed

PART NUMBER	QUANTITY	DESCRIPTION	UNIT PRICE	TOTAL
	1	Timber Tower II SS Slides	\$ 205,700.00	\$ 205,700.00
	1	Log Jam M7	\$ 35,500.00	\$ 35,500.00
	1	Slide Platform 900 SS Slide	\$ 42,750.00	\$ 42,750.00
	1	Log Pile 3.1	\$ 9,500.00	\$ 9,500.00
	1	Songbird	\$ 26,357.00	\$ 26,357.00
	30	Stepper Cluster Access	\$ 450.00	\$ 13,500.00
	1	4'H Triple Wide Concrete Embankment Slide	\$ 28,500.00	\$ 28,500.00
	1	18'H SS Embankment Slide	\$ 55,000.00	\$ 55,000.00
	1	Disk	\$ 16,500.00	\$ 16,500.00
	2	Bog Stilt	\$ 3,150.00	\$ 6,300.00
	4	Notched Post	\$ 1,800.00	\$ 7,200.00
	4	Robinia Stepper	\$ 450.00	\$ 1,800.00
	1	Magnacus	\$ 7,250.00	\$ 7,250.00
	1	Music Ensemble	\$ 16,000.00	\$ 16,000.00
	1	Timber Tower Bridge	\$ 25,000.00	\$ 25,000.00

<b>SUBTOTAL FOR EQUIPMENT</b>			\$	496,857.00
<b>Certified Southern-built™ Installation</b>			\$	149,057.10
SAFETY SURFACE	6500	EWf	\$ 1.50	\$ 9,750.00
SAFETY SURFACE	2000	Bonded Rubber Critical Pathways	\$ 20.00	\$ 40,000.00
BORDER	1	Boulder Package	\$ 55,000.00	\$ 55,000.00
ACCESSIBILTY				\$ -
SITWORK				\$ -
SAFETY				\$ -

SUBTOTAL	\$	750,664.10
TAX RATE		9.00%
SALES TAX		-
BONDS		
EQUIPMENT FREIGHT		18,000.00
SURFACE FREIGHT		2,500.00
<b>TOTAL</b>	<b>\$</b>	<b>771,164.10</b>

Please Note Exclusions and Expectations on Attached Contract Form

Company Mission: Every day our country battles the loneliness epidemic. We help fight back by building beautiful outdoor spaces that offer real connection to families and communities.





Option 1





Timber Tower 2



Concrete Slide



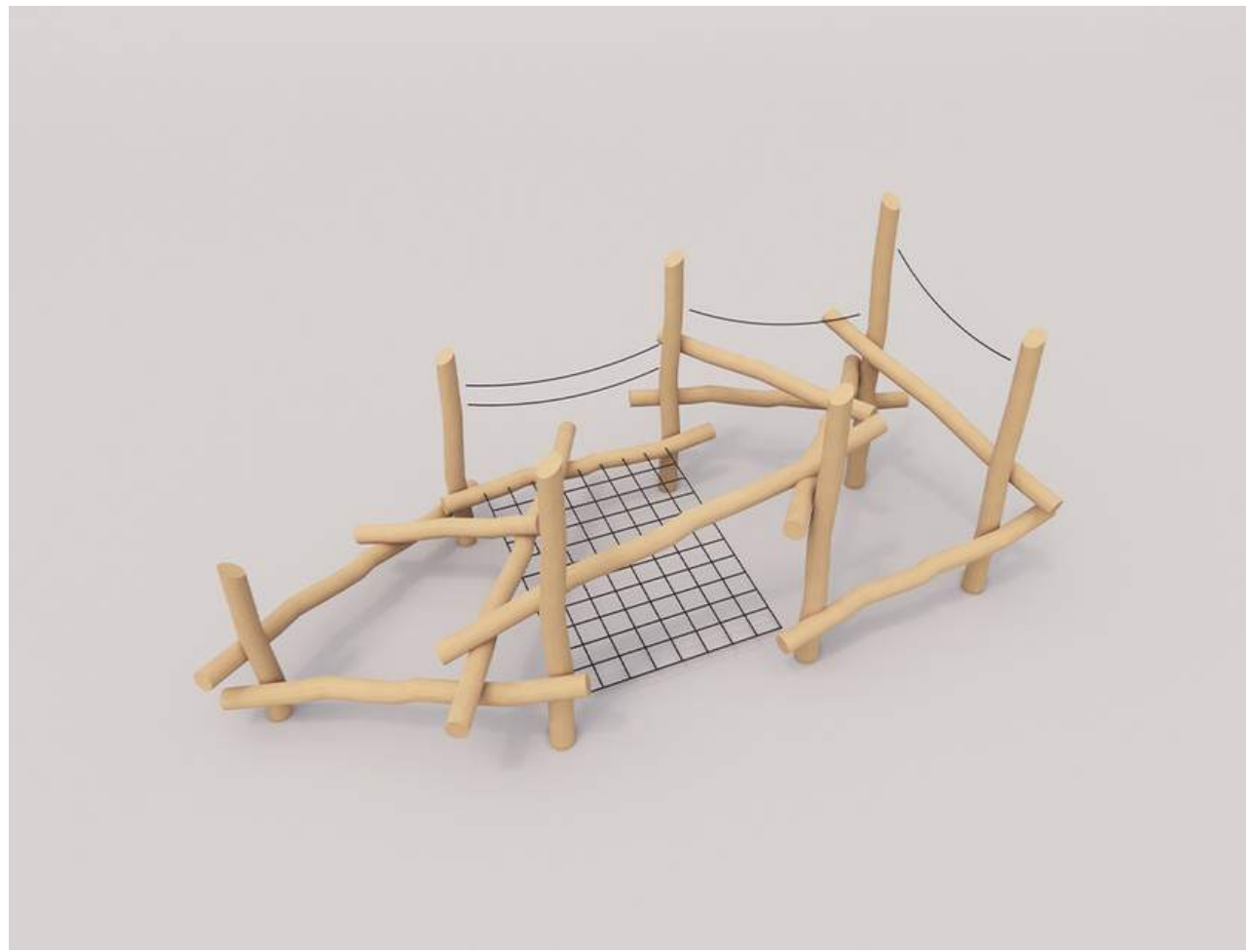

Log Jam M7

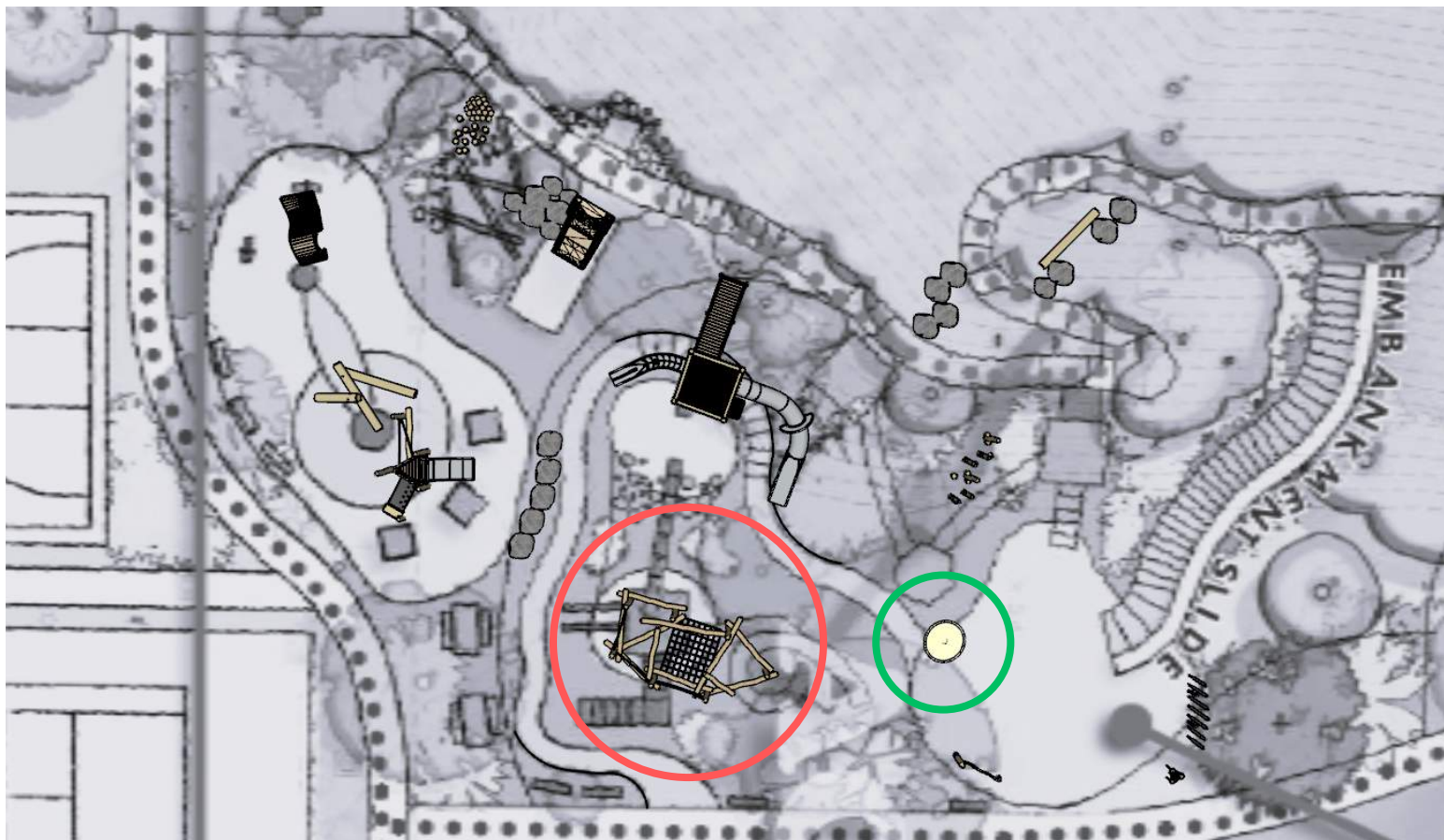

Disk Spinner





Slide Platform 900

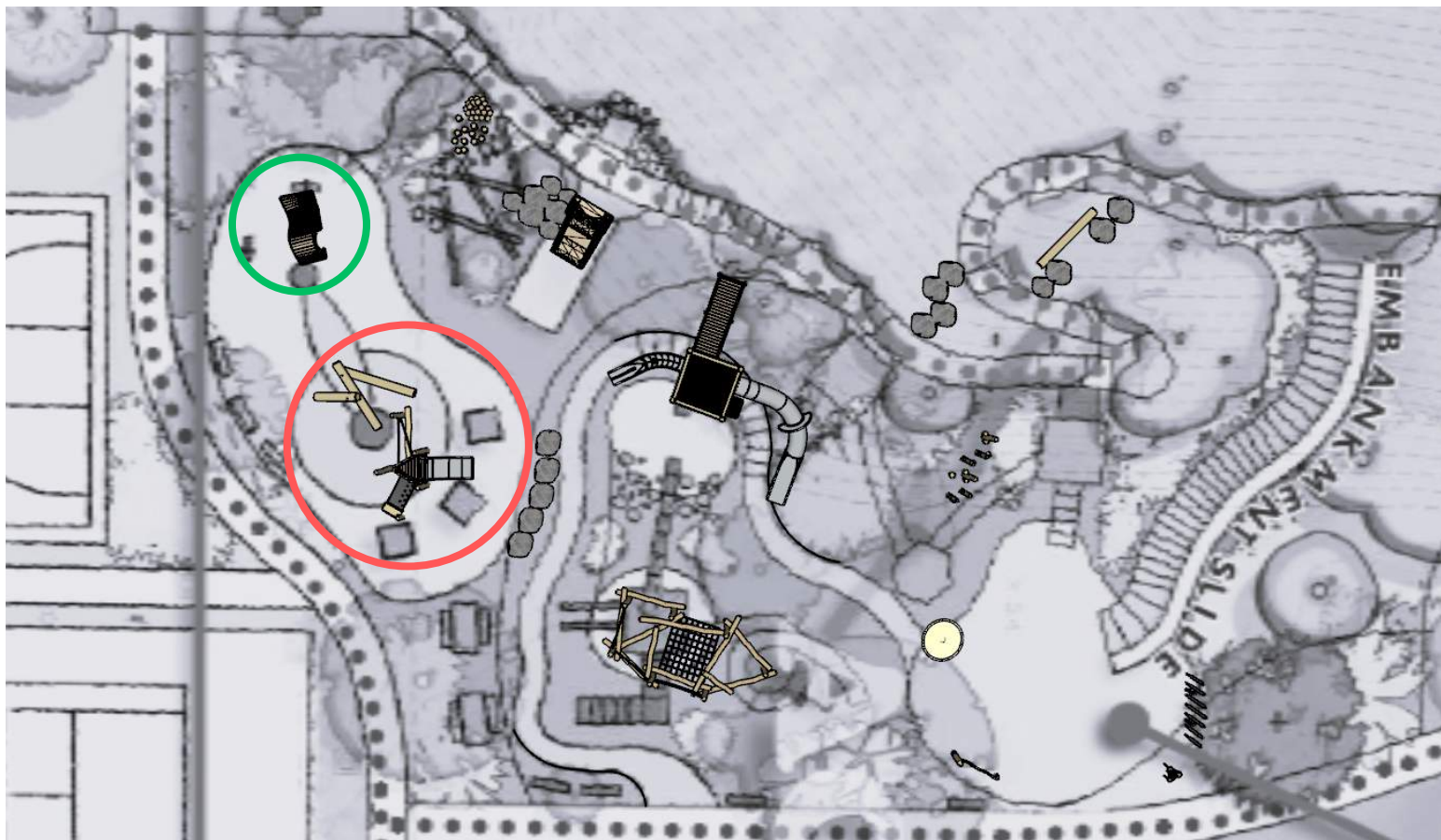

Songbird / Log Pile





Robinia Traverse



Log Round Access





Music Equipment

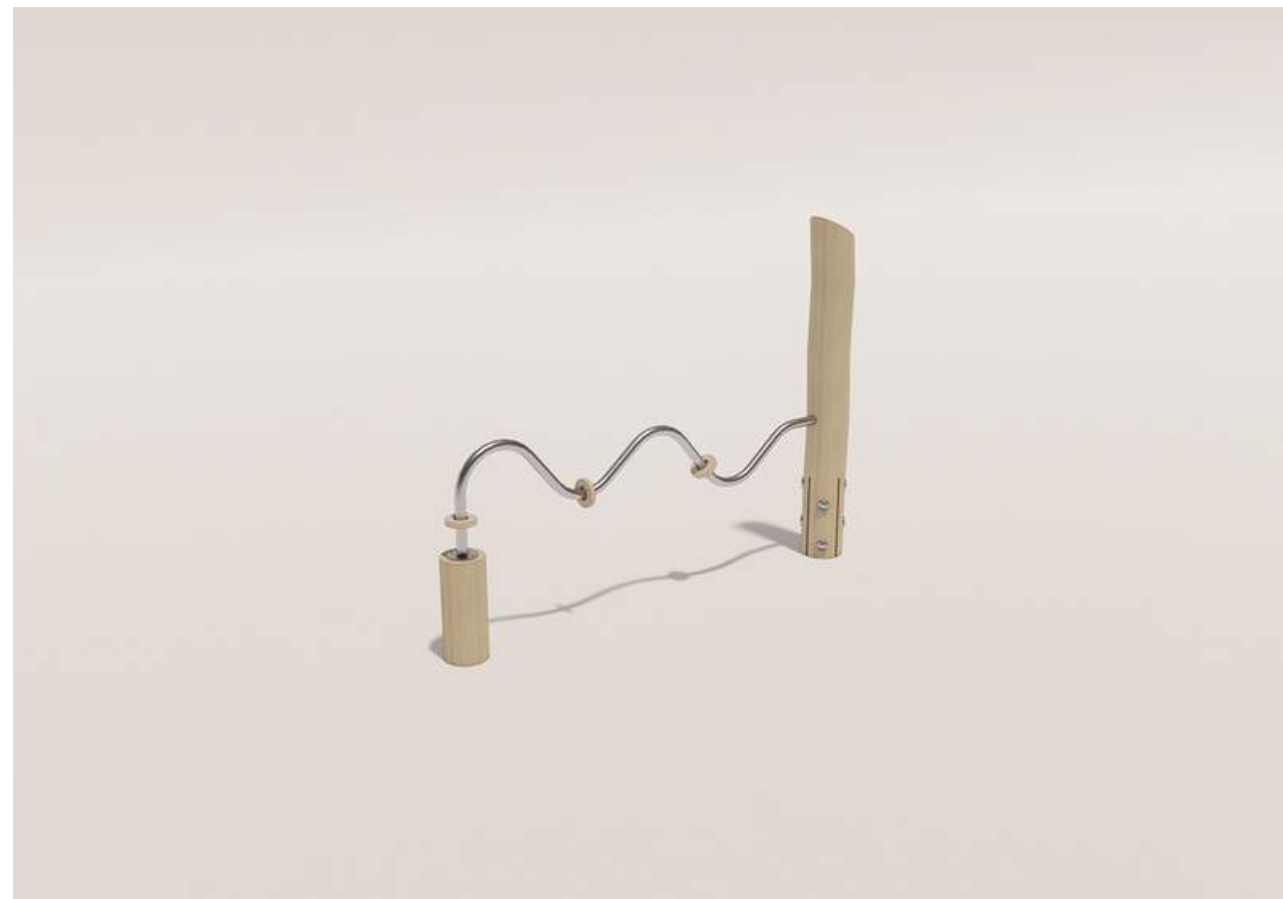

Mangus



# Additional Timber Tower Photos







<b>ORGANIZATION:</b>	
<b>CONTACT:</b>	
<b>ADDRESS:</b>	
<b>PHONE:</b>	

<b>PROJECT TITLE:</b>	Sullivans Island Play Space
<b>REVISION:</b>	
<b>OPTION:</b>	2

## Estimate from Great Southern Recreation

TERRITORY MANAGER	DATE	TERRITORY	COUNTY	TERMS	COLORS
	2/15/2024			Net 30	Confirmed

PART NUMBER	QUANTITY	DESCRIPTION	UNIT PRICE	TOTAL
	1	Log Tower 5	\$ 264,000.00	\$ 264,000.00
	1	Log Jam L16	\$ 83,357.00	\$ 83,357.00
	1	Log Tangle 2.3	\$ 71,200.00	\$ 71,200.00
	1	Mountain Cabin Hut	\$ 17,250.00	\$ 17,250.00
	30	Stepper Cluster Access	\$ 450.00	\$ 13,500.00
	1	4'H SS Embankment Slide	\$ 14,500.00	\$ 14,500.00
	1	18'H SS Embankment Slide	\$ 55,000.00	\$ 55,000.00
	1	Disk	\$ 16,500.00	\$ 16,500.00
	2	Bog Stilt	\$ 3,150.00	\$ 6,300.00
	4	Notched Post	\$ 1,800.00	\$ 7,200.00
	4	Robinia Stepper	\$ 450.00	\$ 1,800.00
	1	Magnacus	\$ 7,250.00	\$ 7,250.00
	1	Music Ensemble	\$ 16,000.00	\$ 16,000.00
				\$ -

<b>SUBTOTAL FOR EQUIPMENT</b>				\$ 573,857.00
<b>Certified Southern-built™ Installation</b>				\$ 172,157.10
SAFETY SURFACE	6500	EWf	\$ 1.50	\$ 9,750.00
SAFETY SURFACE	2000	Bonded Rubber Critical Pathways	\$ 20.00	\$ 40,000.00
BORDER	1	Boulder Package	\$ 55,000.00	\$ 55,000.00
ACCESSIBILTY				\$ -
SITWORK				\$ -
SAFETY				\$ -

<b>SUBTOTAL</b>	\$ 850,764.10
<b>TAX RATE</b>	9.00%
<b>SALES TAX</b>	-
<b>BONDS</b>	
EQUIPMENT FREIGHT	18,000.00
SURFACE FREIGHT	2,500.00
<b>TOTAL</b>	\$ 871,264.10

Please Note Exclusions and Expectations on Attached Contract Form

Company Mission: Every day our country battles the loneliness epidemic. We help fight back by building beautiful outdoor spaces that offer real connection to families and communities





Option 2





Log Tower 5

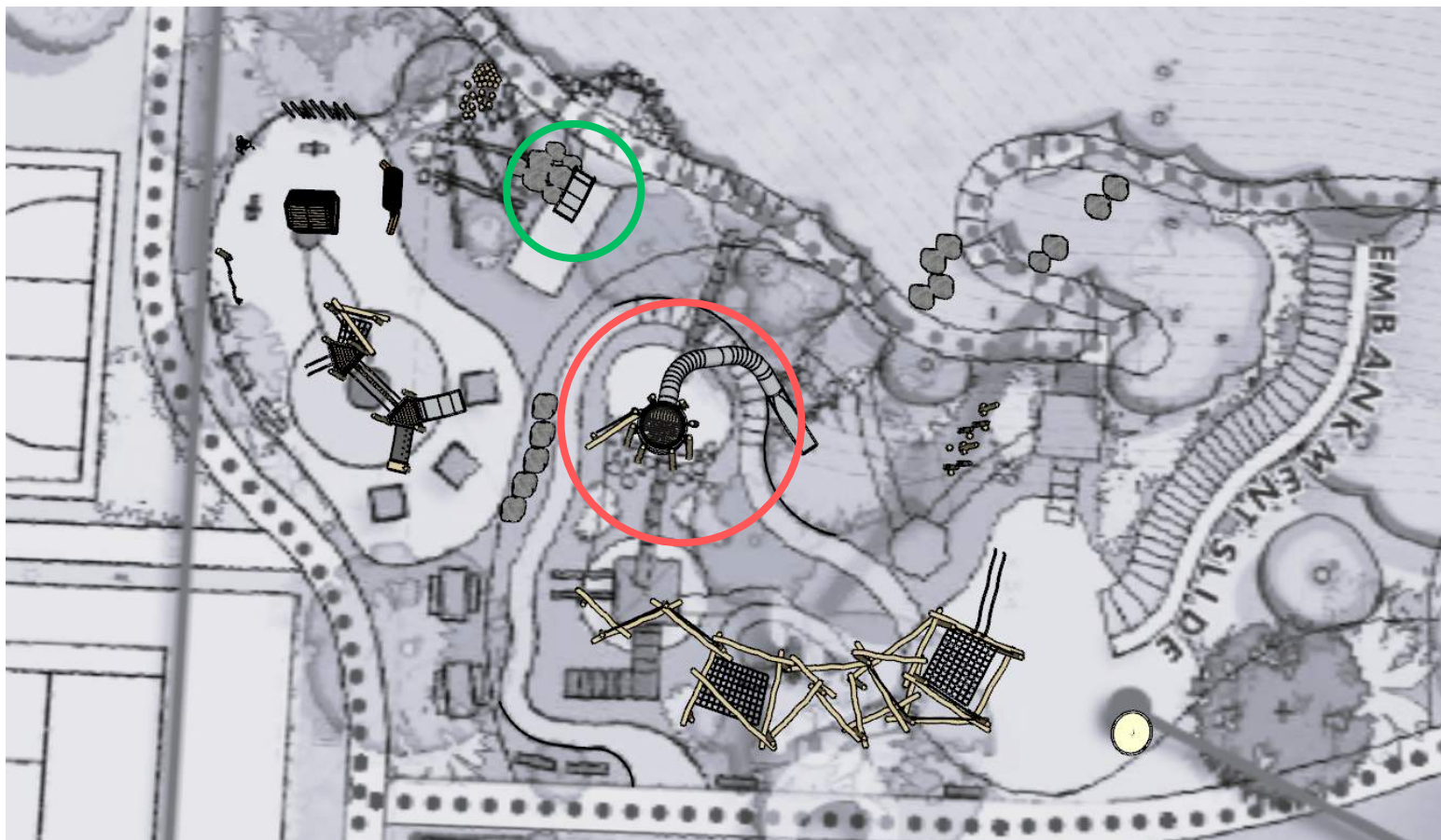

Concrete Slide





Log Tangle 2.3



Mountain Cabin



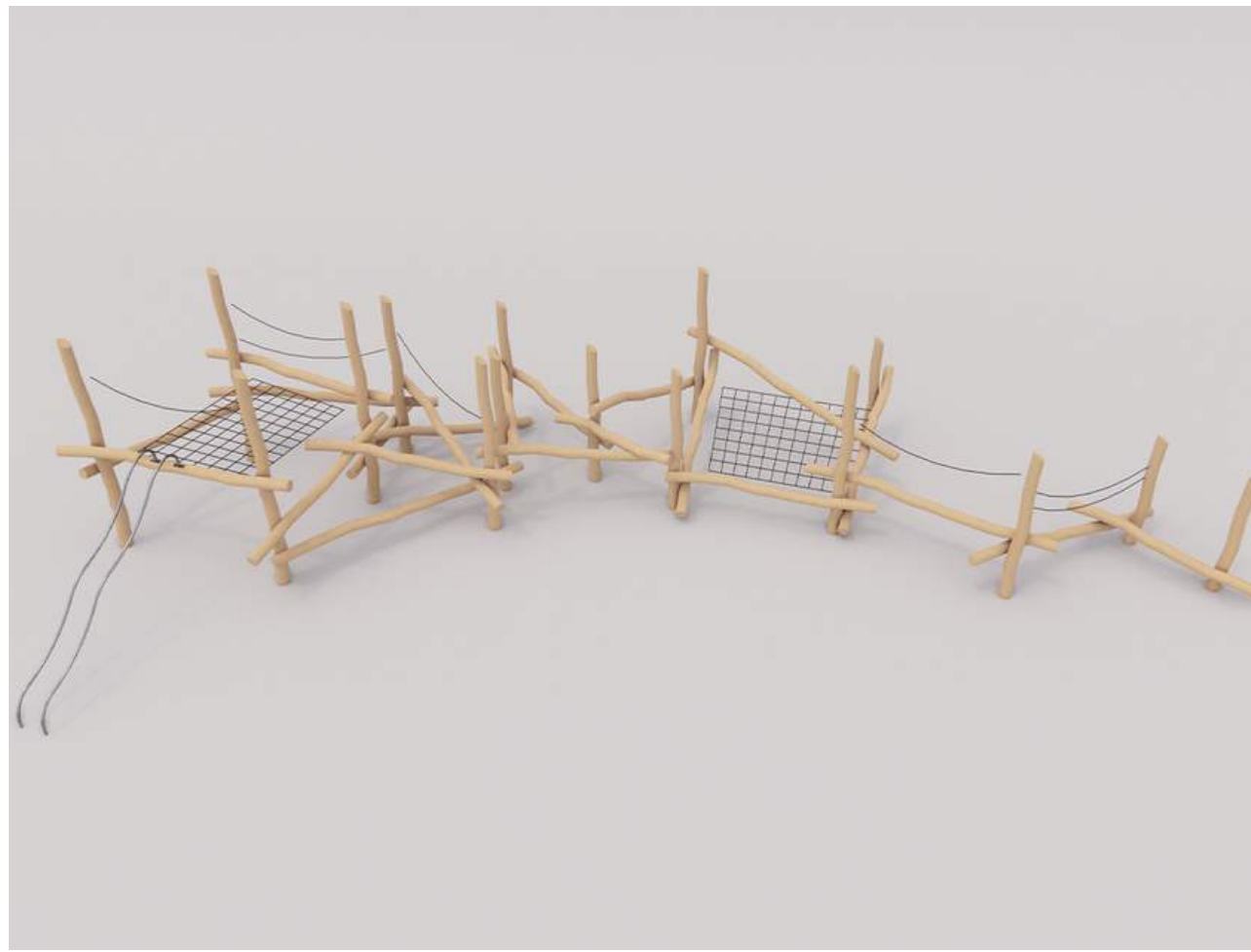

Log Jam L16

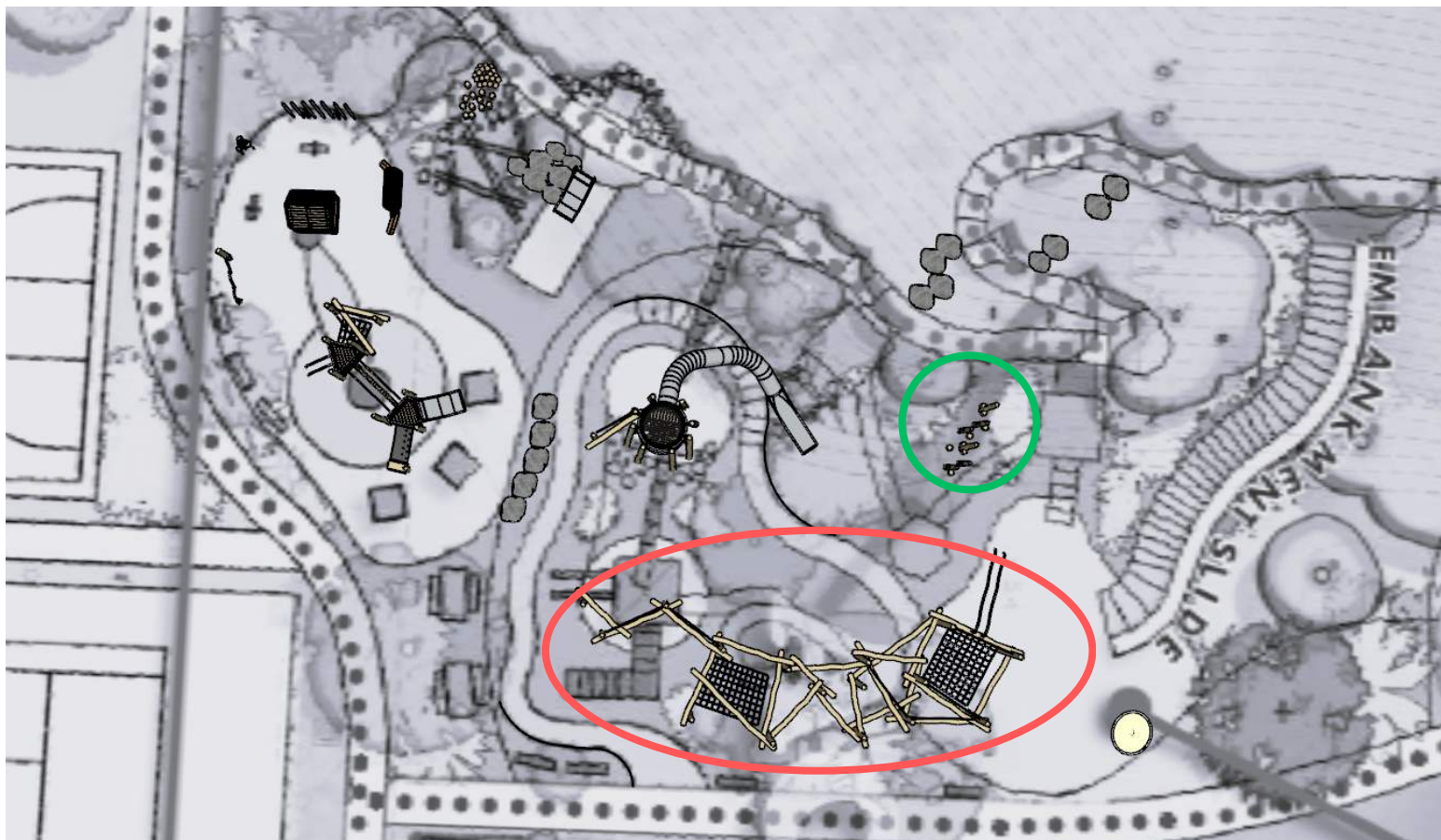

Robinia Traverse





Music Equipment

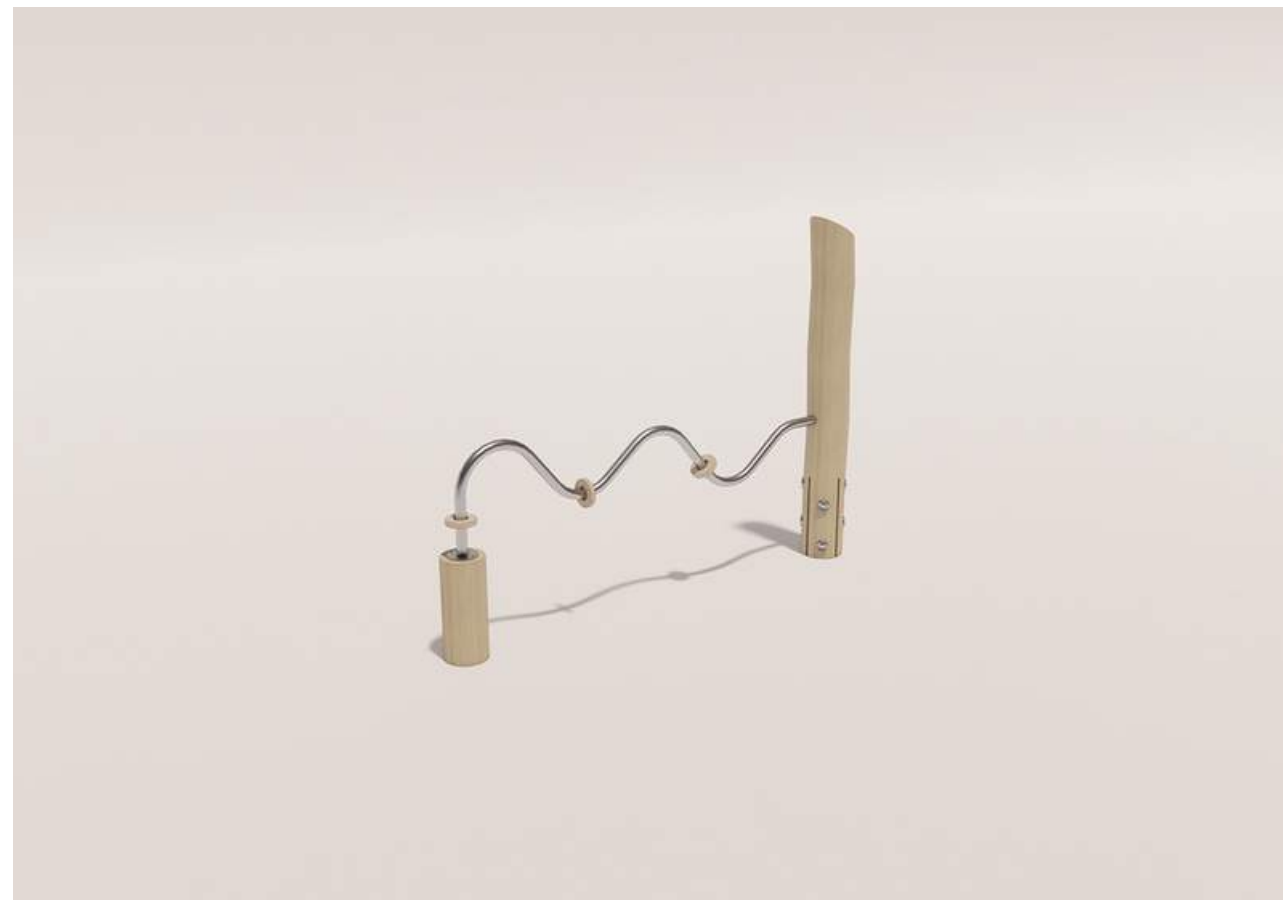
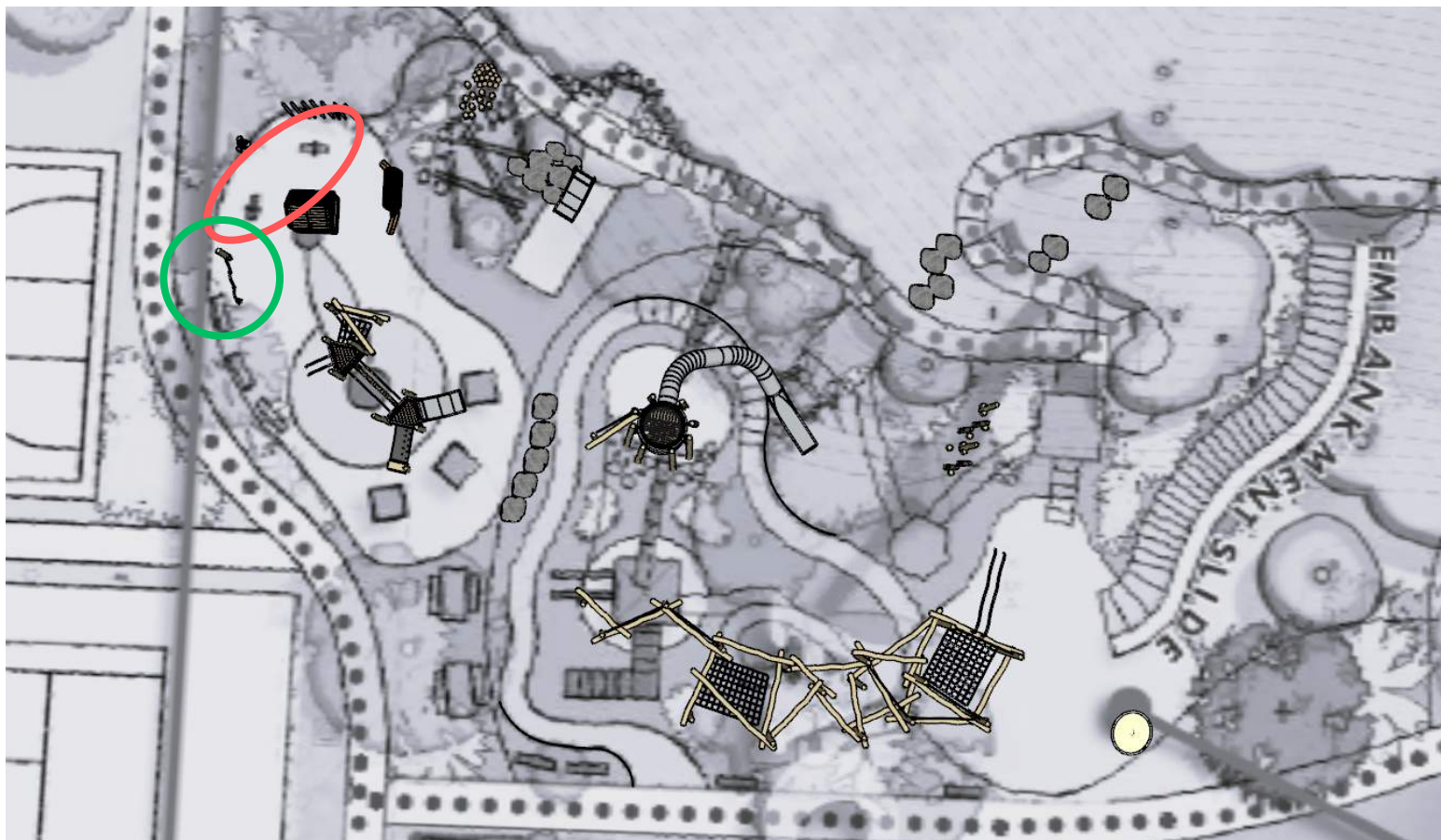

Mangus



# Additional Log Tower Photos

