

EXISTING CONDITIONS



HISTORY



CHARLESTON LIGHT | GUIDING MARINERS INTO HARBOR SINCE 1962



BATTLE OF SULLIVAN'S ISLAND | AMERICAN REVOLUTIONARY WAR 1776



PITT STREET BRIDGE | TROLLEY TRANSPORTATION TO AND FROM SULLIVAN'S ISLAND 1898-1927



J. MARSHALL STITH PARK MASTER PLAN SULLIVANS ISLAND, SC

AUGUST 2023

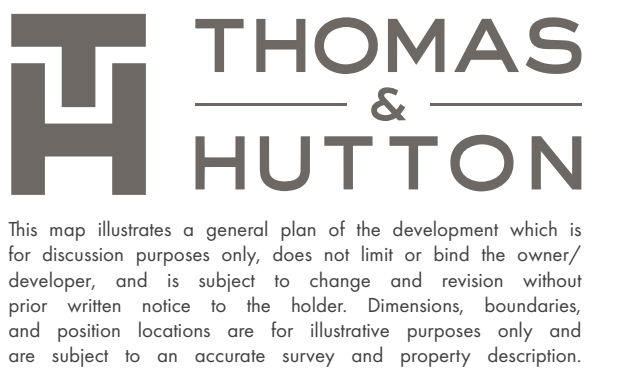

This map illustrates a general plan of the development which is for discussion purposes only, does not limit or bind the owner/developer, and is subject to change and revision without prior written notice to the holder. Dimensions, boundaries, and position locations are for illustrative purposes only and are subject to an accurate survey and property description.

SCHEMATIC PLAN



THE STITH PARK MASTER PLAN WILL PROVIDE A FRAMEWORK FOR IMPROVEMENTS THAT WILL BE A BENEFIT TO THE ISLAND COMMUNITY. THE MASTER PLAN WILL FOCUS ON THE FOLLOWING OBJECTIVES.

- CREATE A PARK SPACE THAT REFLECTS THE BEACH LIFESTYLE AND AMBIANCE OF SULLIVAN’S ISLAND
- CREATE AN **INCLUSIVE** PLAYGROUND FOR KIDS OF ALL AGES
- UTILIZE THE EXISTING MOUND AS AN OPPORTUNITY FOR CREATIVE PLAY AND PROGRAMMING WITHIN THE PARK
- STUDY OPPORTUNITIES FOR ADDITIONAL PROGRAMMING THAT MAY INCLUDE: ADDITIONAL SPORT COURTS, PICKLE-BALL COURTS, ADULT EXERCISE AREA, ETC.
- IMPROVE THE EXISTING DRAINAGE SYSTEM WITHIN THE PARK SPACE
- EXPLORE ADDITIONAL OPPORTUNITIES AND PROGRAMMING THAT MAY BE PRESENTED DURING THE PUBLIC INPUT PROCESS

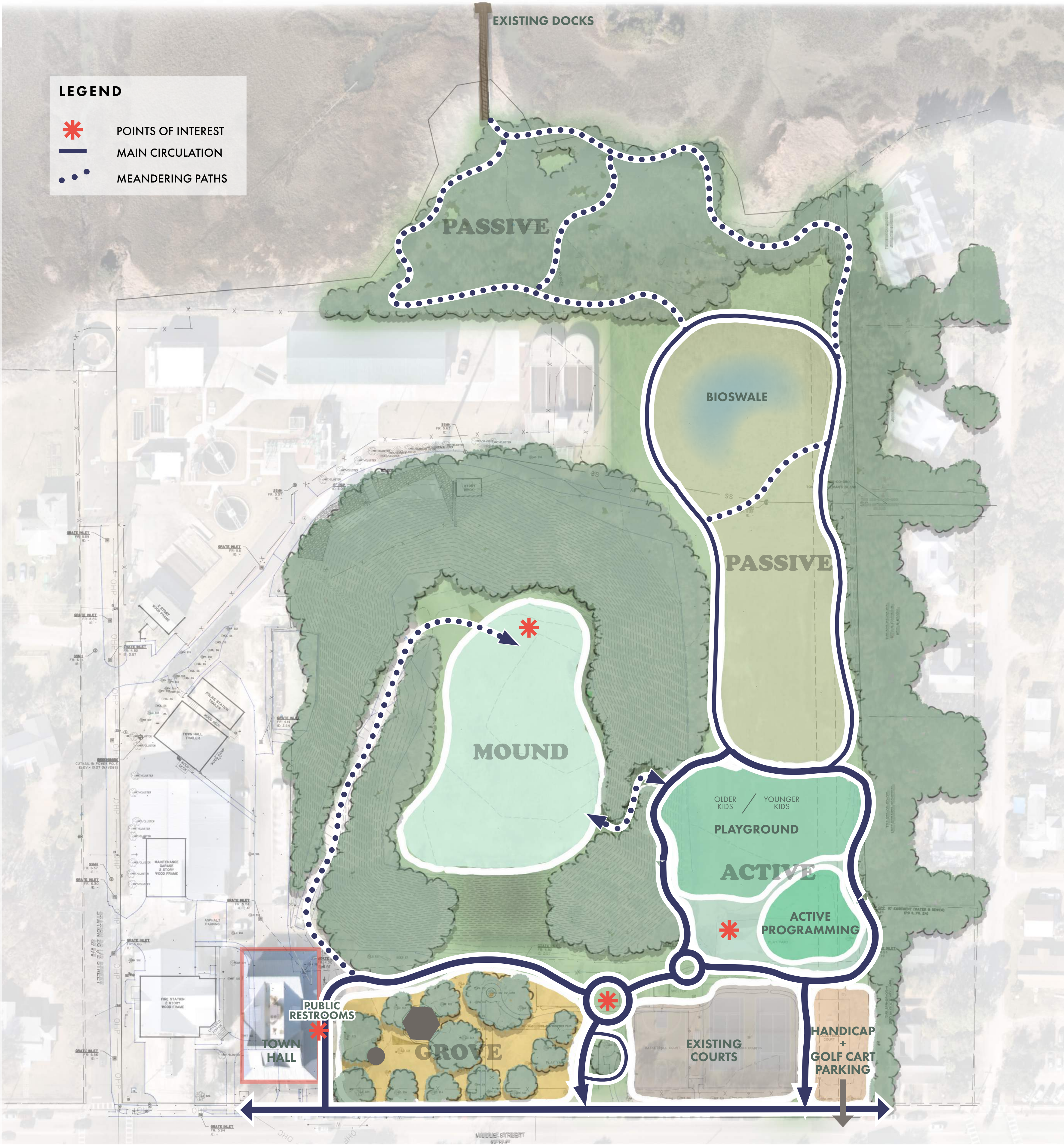

J. MARSHALL STITH PARK MASTER PLAN

SULLIVANS ISLAND, SC

AUGUST 2023

NATURE MEETS PLAY

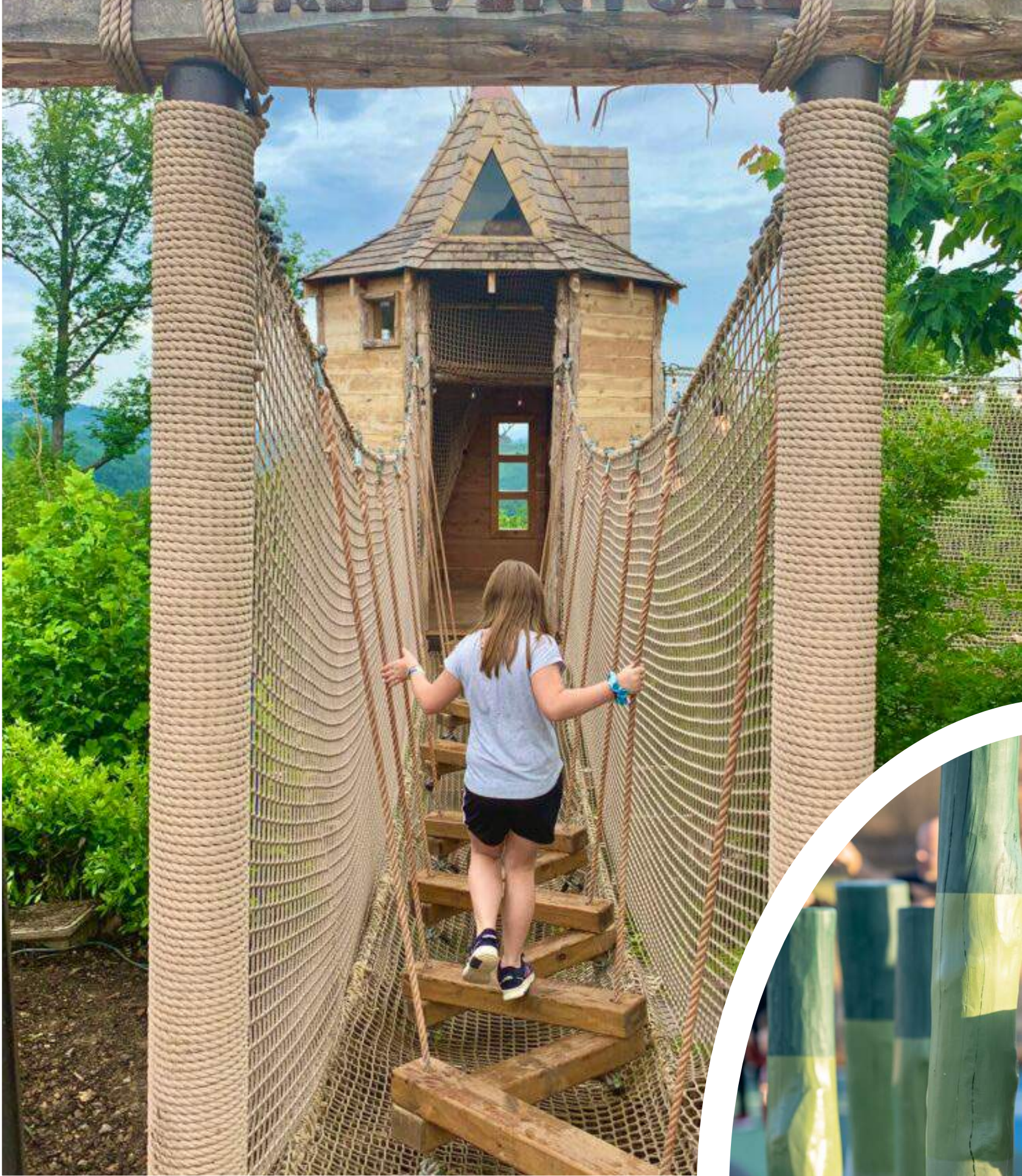
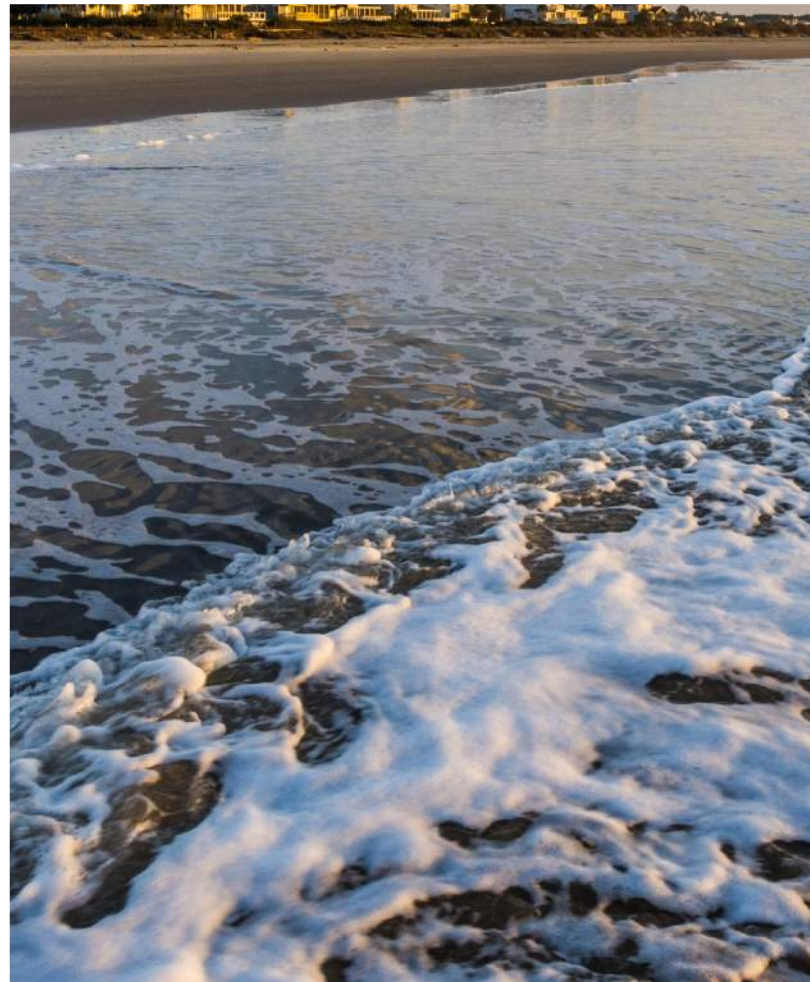
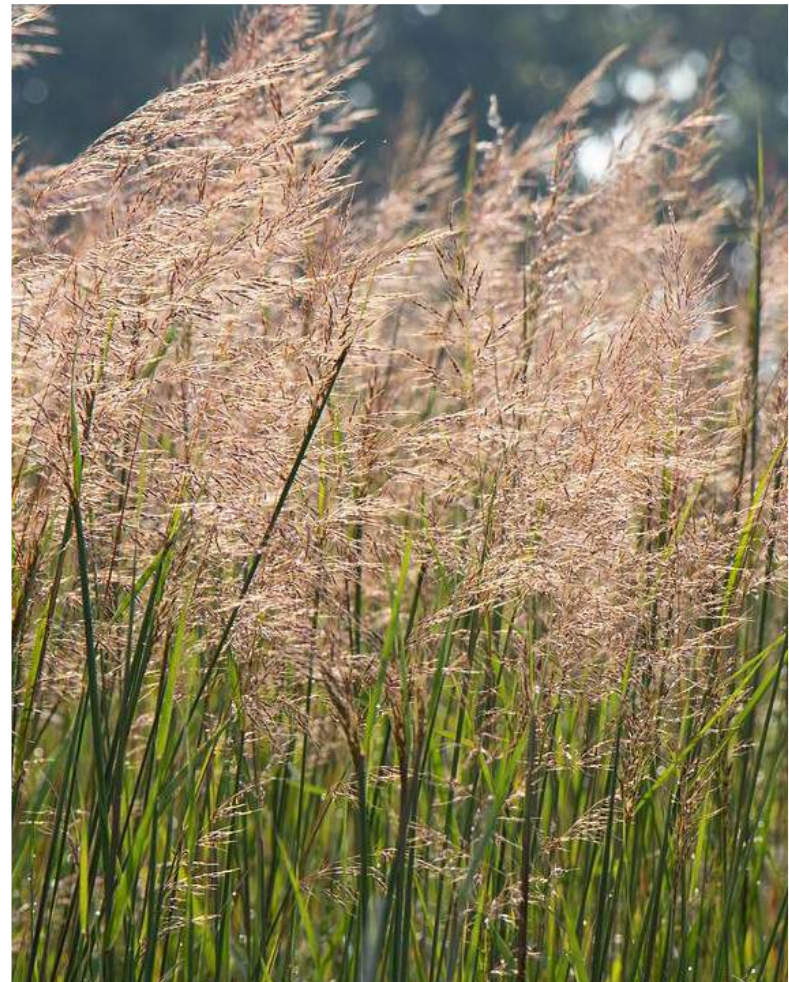

J. MARSHALL STITH PARK MASTER PLAN
SULLIVANS ISLAND, SC

AUGUST 2023



PLAYGROUND STYLES

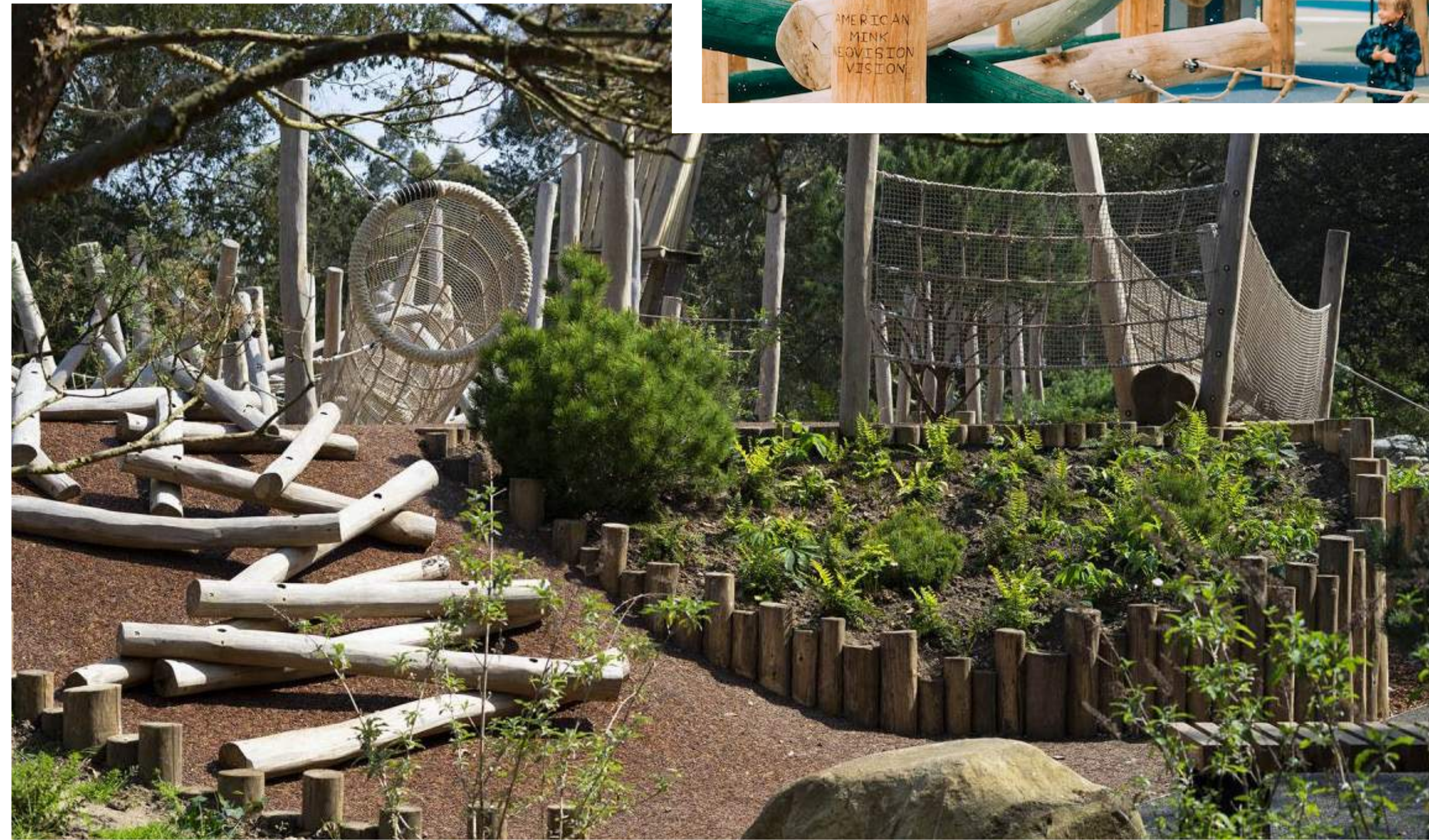

J. MARSHALL STITH PARK MASTER PLAN SULLIVANS ISLAND, SC

AUGUST 2023

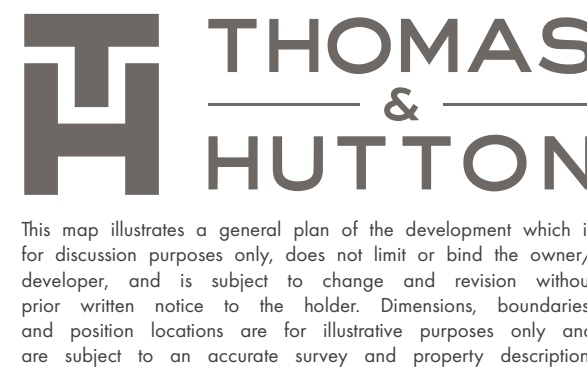

This map illustrates a general plan of the development which is for discussion purposes only, does not limit or bind the owner/developer, and is subject to change and revision without prior written notice to the holder. Dimensions, boundaries, and position locations are for illustrative purposes only and are subject to an accurate survey and property description.

MOUND

“THE MOUND WAS BATTERY CAPRON, AN AMERICAN ARMY AMMUNITION STORE AND MORTAR BATTERY CONSTRUCTED IN 1898 FOR \$175,000. THE EARTH AND REINFORCED CONCRETE STRUCTURE WAS PART OF THE ENDICOTT SYSTEM OF SEACOAST DEFENSE. IT WAS ACTIVE FROM THE OUTSET OF THE SPANISH-AMERICAN WAR THROUGH MUCH OF WORLD WAR II”

“NOW, KIDS USE CARDBOARD TO SLIDE DOWN ITS FACE. A LARGE GRASSY FIELD, THICK STANDS OF BAMBOO AND A FEW CRUMBLING BUILDINGS MARKED WITH GRAFFITI ARE AT THE TOP.”
-POST AND COURIER



EXISTING MOUND ACTION!



PLAY

ENTERTAINMENT & ADVENTURE

MOVIES ON THE MOUND



ENHANCED WALKING PATHS UP & DOWN THE MOUND



OBSERVATION TOWER TO CAPTURE VIEWS OF INTRACOASTAL



20' HIGH VIEW



50' HIGH VIEW



J. MARSHALL STITH PARK MASTER PLAN

SULLIVANS ISLAND, SC

AUGUST 2023



This map illustrates a general plan of the development which is for discussion purposes only, does not limit or bind the owner/developer, and is subject to change and revision without prior written notice to the holder. Dimensions, boundaries, and position locations are for illustrative purposes only and are subject to an accurate survey and property description.

GROVE



MUSIC AT THE GROVE



MARKET IN THE GROVE



COMMUNITY GATHERINGS

PASSIVE



MULTI-USE SPORTS FIELD

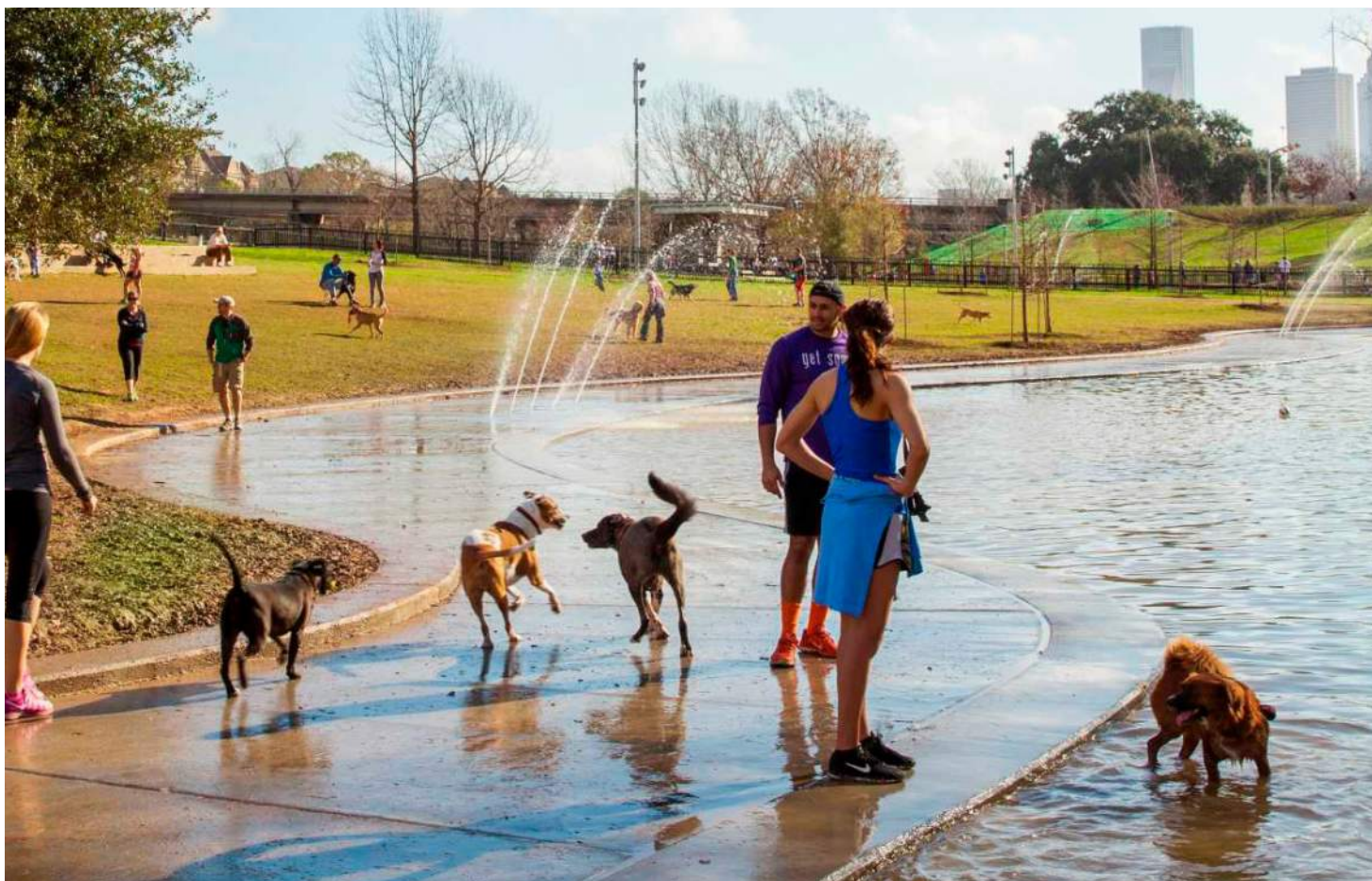

DOG PARK



AREAS FOR REST AND REFUEL



ACTIVE



SAND VOLLEYBALL



MULTI-USE SPORT COURTS



OUTDOOR GAMES



OUTDOOR WORKOUT AREA



WALKING PATHS

