



Town of Sullivan's Island

Sullivan's Island, South Carolina

STORMWATER MANAGEMENT PLAN CERTIFICATION

Ratification Date: September 20, 2016

A Stormwater Management Plan with Narrative/Plan Notes must be submitted with all Building Permit applications for residential and nonresidential construction projects meeting the following criteria:

1. Adding or replacing 625 square feet of impervious surface (building surfaces, roofs, driveways, patios, decks, pools, etc.);
2. Adding fill or regrading by more than 20% of the existing lot area.

*This plan shall be a **separate sheet(s)** included with the Building Permit plan submittal and must be prepared by a professional engineer and/or registered landscape architect licensed in South Carolina. The plan must comply with the following standards and guidelines required by the Town's Zoning Ordinance (§21-17) and Stormwater Management Utility (Town Code Chapter 25):*

I. Stormwater Plan & Survey

- Signed *Stormwater Management Plan Certification* form
- A to scale site plan corresponding with a current survey, illustrating contour/topography lines, property boundaries, scale, and property ownership information (address, TMS#, etc.)
- Lot elevation at property corners, building pad, and lot elevations 10' within adjacent properties (this must be determined when adding fill to the property line)
- Spot elevations of low points
- DHEC-OCRM Critical Line and/or Baseline and Setback line
- Easements (include recording numbers if applicable)
- Existing and proposed structures including setbacks
- Location of trees to be removed and saved
- Location of existing and proposed stormwater drainage facilities such as roof downspouts, pipes, catch basins, grates, splash blocks, dispersion trenches, dispersion buffers, vegetated flow paths, infiltration trenches, etc.
- Existing and proposed structures (including bulkheads, retaining walls, etc.)
- Existing and proposed impervious surfaces such as driveways, patios, buildings, parking areas, sport courts etc.
- Proposed drainage flow patterns for surface runoff
- Construction details for proposed stormwater drainage facilities
- Location of adjacent public stormwater drainage facilities such as ditches and catch basins
- Location of water and sanitary sewer service
- Proposed temporary erosion and sediment control measures such as silt fencing, construction entrances, interceptor swales, etc. (Shown on plan)

II. Stormwater Management Narrative/Report

- Summary of existing and new impervious areas
- Summary of drainage design for surface runoff where no area drains and pipe collection systems are proposed
- Summary of proposed Best Management Practices (BMPs) and confirmation of regular inspection and maintenance schedule of onsite BMPs

*****An as-built survey may be required for any new construction and substantial improvement.**

SITE PLAN
(Sample Only)

- X Spot elevations
- ⊗ Proposed elevation

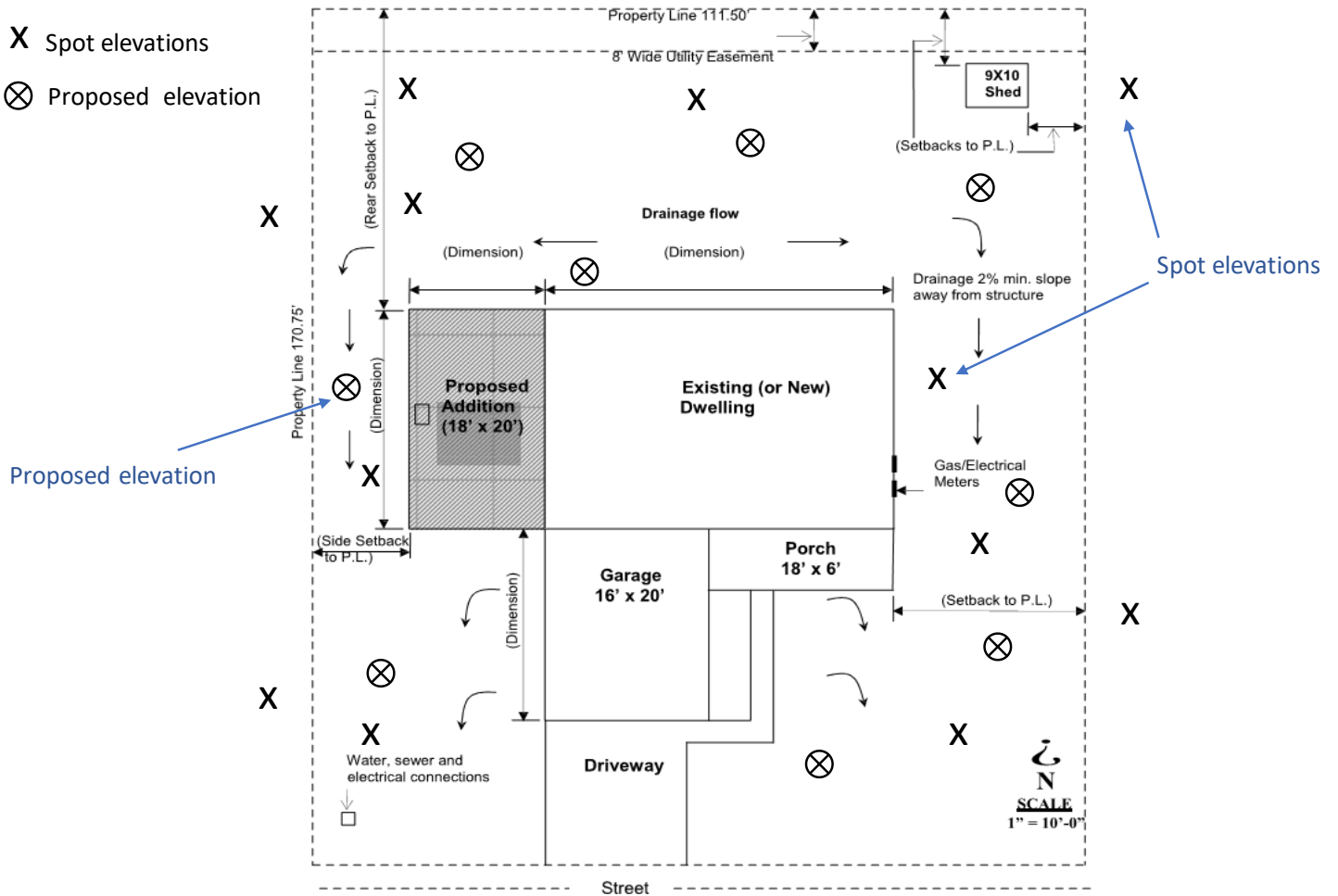

Owner's Name _____ Building Permit # _____

Project Address _____ TMS# _____

Contractor Name _____

Under my credentials as a licensed professional engineer, or SC registered landscape architect, I hereby certify that the stormwater control measures, and the final grading for this project, will be completed in accordance with the plan and specifications detailed. I further certify that a post-development as-built survey will confirm compliance with the approved stormwater management plan prior to receiving a **Certificate of Completion** or prior to the issuance of a **Certificate of Occupancy**.

Property Owner's Signature _____ Date: _____

Professional Engineer/ RLA Signature: _____ Date: _____

Professional Engineer/ RLA Signature: _____ Completion Date: _____